

Indico 100[®] SP

GENERATOR PERFORMANCE MATRIX

Product Name	Indico 100 [®] SP (80 kW)	Indico 100 [®] SP (100 kW)
Application	RF, Multi Purpose & Angiographic Special Procedures.	RF, Multi Purpose & Angiographic Special Procedures.
Generator Type	High Frequency Output 200 kHz +	High Frequency Output 200 kHz +
kV (Radiographic)	40 – 150 kV	40 – 150 kV
kV (Fluoroscopic)	40 – 125 kV	40 – 125 kV
mA Range RAD	10 – 1000 mA	10 – 1000 mA
mA Range FLUORO ¹	0.5 – 10 mA continuous	0.5 – 10 mA continuous
Rotor Supply	Dual Speed – Standard	Dual Speed – Standard
Line Nominal/Phase	3 Ø 400 or 480 VAC	3 Ø 400 or 480 VAC
Line Voltage Range	± 10%	± 10%
High Voltage Ripple (typ.)	<1 kV @ 100 kV	<1 kV @ 100 kV
Number of X-Ray Tubes	1 Tube Capability	1 Tube Capability
Timer Rang, Programmable	*	*
Anatomical Programs ⁶	20,000 techniques capacity plus	20,000 techniques capacity plus
mAs Range Non AEC ^{3*}	0.1 – 1000 mAs	0.1 – 1000 mAs
Number of Image Receptors	6	6
Technique Selection	1. kV with AEC option 2. kV/mAs 3. kV/mA/Time	1. kV with AEC option 2. kV/mAs 3. kV/mA/Time
Exposure Hand Switch	Standard	Standard
Documentation ⁵	Manual or CD	Manual or CD
GenWare [®] Service Software	Yes	Yes
OPTIONS		
Touch Screen Console	Yes	Yes
Touch Screen Console Wall Mount	Yes	Yes
AEC Interface	Ionization, PMT, or Solid State	Ionization, PMT, or Solid State
ABS Interface	PMT, Photo Diode, Video or Proportional DC	PMT, Photo Diode, Video or Proportional DC
High Level Continuous Fluoroscopy	Up to 20 mA	Up to 20 mA
Pulsed Fluoroscopy	Up to 40 mA	Up to 40 mA
High Level Pulsed Fluoroscopy ⁴	Up to 80 mA	Up to 80 mA
kV/mAs Stepping	Yes	Yes
DR/CR/RF Interfaces ^{2*}	Yes	Yes
CINE ^{2*}	Yes	Yes
CINE ^{2*} (ISO Watt Mode)	Yes	Yes
Dose Area Product (DAP) Interface	Yes	Yes
Air Kerma Readout	Yes	Yes
Second Tube Capability	Yes	Yes
Wheels ⁵	Yes	Yes
Custom Interfaces*	Yes	Yes
Active Dose Reduction (ADR)	Yes	Yes
3 Dose and Transfer Curves	Yes	Yes
S.I.D. Compensation*	Yes	Yes
Tri-Focus Operation *	Yes	Yes
Second Filament Drive	Yes	Yes
Cabinet Wiring Cover*	Yes	Yes
Auxiliary Collimator Power*	Yes	Yes

* Consult Factory for details.

1. Maximum Fluoroscopic kV is 125 kV – programmable to 110 kV for European requirements.

2. Compatible with Digital Imaging System – Consult Factory.

3. The mAs limit may be de-rated by software.

4. Consult Factory for higher mA values.

5. To be identified on order.

6. Touchscreen specification only.



Indico 100[®] SP

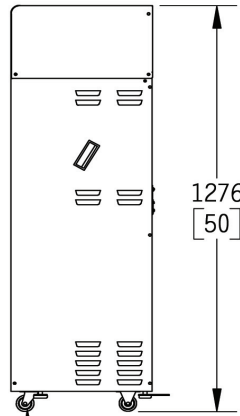
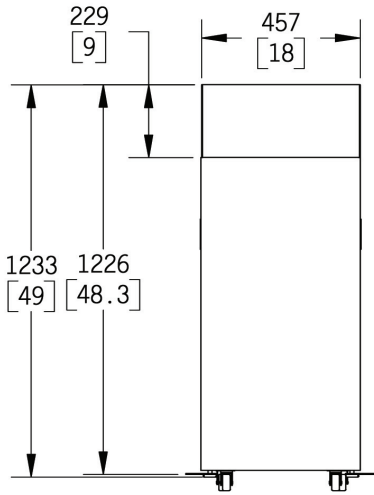
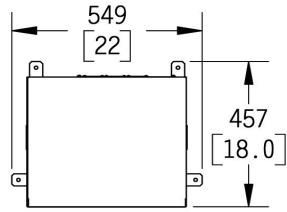

Wheels (Optional)

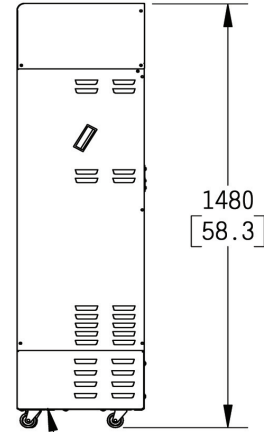

Auxiliary Cabinet (Optional)

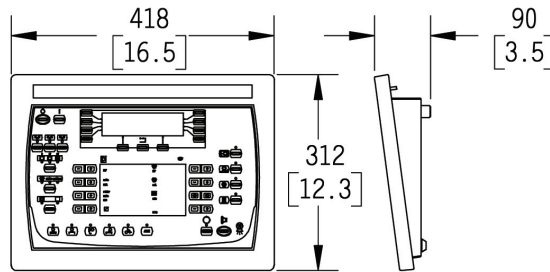

Indico 100[®] RF Console



CPI Touch Screen Console (Optional)

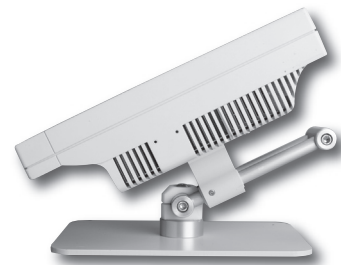

Desktop Base (Optional)



Wall Mount (Optional)

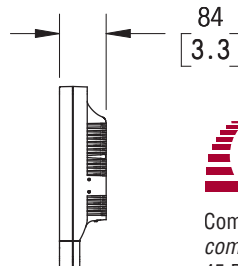
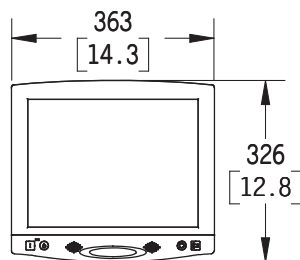

Communications & Power Industries Canada Inc.
 communications & medical products division
 45 River Drive / Georgetown, Ontario / Canada L7G 2J4
 Hot Line Telephone: 1-888-CPI-XRAY
 TEL: 905-877-0161 / FAX: 905-877-5327
 E-MAIL: marketing@cmp.cpii.com
 WEB: www.cpii.com/cmp



All dimensions are in mm [inches]